



# NPL12900M

General Purpose AGM Battery

## General Features

- High performance, completely maintenance-free, low self-discharge
- 100% precise quality testing, stable quality and high reliable performance
- Unique grid alloy formula and updated manufacturing technique
- Floating & standby use: up to 8 years
- Cycle use 1: Up to 260 cycles at 100% DOD
- Cycle use 2: Up to 500 cycles at 50% DOD

## Application

- Telecommunications
- Alarm and security system
- DC power supply
- Electric Power System (EPS)
- Uninterruptable Power Supply (UPS)
- Communication power supply
- Auto control system
- Emergency backup power supply

## Specification

Battery Model	NPL12900M 12V90AH			
Designed Floating Life	Up to 10 Years			
Capacity (25°C)	20HR(4.88A,10.8V)	97.60AH		
	10HR(9.20A,10.8V)	92.00AH		
	5HR(17.90A,10.5V)	89.50AH		
	5HR(17.90A,10.5V)	59.93AH		
Dimensions	Length	305mm(12.01inch)		
	Width	167mm(6.57inch)		
	Height	210mm(8.27inch)		
	Total Height	213mm(8.39inch)		
Approx. Weight	26.50Kg (59.62 lbs) +/-5%			
Internal Resistance	Full charged at 25°C: ≤8.0mΩ			
Self Discharge	2% of capacity declined per month at (25°C)			
Capacity Affected by Temp.(20HR)	40°C	25°C	0°C	-15°C
	102%	100%	85%	65%
Charge Voltage(25°C)	Cycle use		Float use	
	14.4-14.6V(-30mV/°C) ,Max Current: 9.90A		13.60-13.80V (-20mV/°C)	

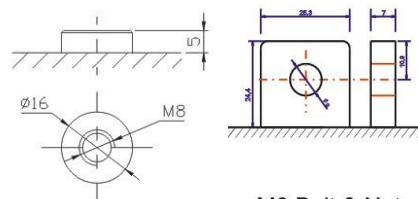

B4 Terminal

M8 Bolt & Nut

T13 Terminal

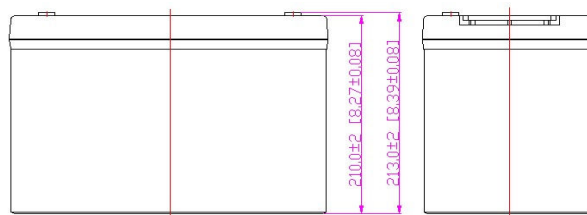
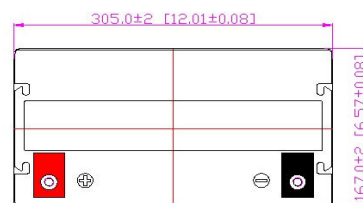

This information is generally descriptive only and is not intended to make or imply any representation, guarantee or warranty with respect to any cells and batteries. Cell and Battery designs/specification are subject to modification without notice. Contact YHI Power for latest information.

YHI POWER Pty. Ltd Melbourne Head Office: 20 22 Venture Way, Braeside, VIC 3195 Ph: 03 9588 1888 Web: yhipower.com.au

**Charge Performance**

<b>Constant Current Discharge(CC,Unit:A) at 25°C(77°F)</b>												
F.V/Time	5Min	10Min	15Min	30Min	1Hr	2Hr	3Hr	4Hr	5Hr	6Hr	10Hr	20Hr
1.85V/Cell	327.04	193.06	151.73	98.91	57.73	33.37	25.62	21.04	17.24	14.06	9.04	4.79
1.80V/Cell	333.29	196.74	154.63	100.80	58.83	34.01	26.11	21.44	17.57	14.33	9.20	4.88
1.75V/Cell	339.54	200.43	157.53	102.69	59.93	34.64	26.60	21.85	17.90	14.59	9.38	4.97
1.70V/Cell	370.09	212.46	166.98	106.79	60.99	35.25	27.07	22.23	18.22	14.85	9.55	5.06
1.67V/Cell	407.44	230.50	181.16	112.75	61.64	35.63	27.36	22.47	18.41	15.01	9.65	5.12

<b>Constant Power Discharge (CP,Unit:W) at 25°C(77°F)</b>												
F.V/Time	5Min	10Min	15Min	30Min	1Hr	2Hr	3Hr	4Hr	5Hr	6Hr	10Hr	20Hr
1.85V/Cell	637.73	376.46	295.88	192.87	112.56	65.07	49.97	41.03	33.62	27.41	17.63	9.34
1.80V/Cell	649.91	383.65	301.53	196.56	114.71	66.31	50.92	41.82	34.27	27.93	17.94	9.52
1.75V/Cell	662.09	390.84	307.19	200.24	116.87	67.56	51.88	42.60	34.91	28.46	18.30	9.70
1.70V/Cell	721.68	414.29	325.62	208.23	118.92	68.74	52.79	43.35	35.52	28.96	18.62	9.87
1.67V/Cell	794.51	449.47	353.26	219.87	120.20	69.48	53.36	43.81	35.90	29.27	18.82	9.97

