



**BOSCH**

Invented for life

# Bosch SMT Mega Power Plus

## 68032-S – 12V Calcium, Calcium Technology

### Applications

Automotive Passenger Vehicles

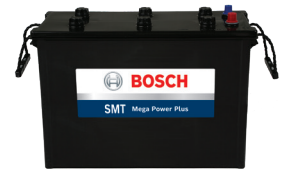

### Bosch Master Data

Short Order Part Number

68032-S

Product Series

SMT Mega Power Plus

Bosch 13 Digit Part Number

0092T47030C1U

Technology

Calcium, Calcium

EAN Barcode

4047026449426

Warranty Period

Refer [www.boschaftermarket.com.au](http://www.boschaftermarket.com.au)

Refer [www.boschaftermarket.co.nz](http://www.boschaftermarket.co.nz)

### Technical Information

Nominal Voltage

12V

Nominal Capacity (20HR)

180 AH

Reserve Capacity

360 Mins

Cold Cranking Amperes (CCA)

1100 Amps

#### Case Size Dimension

Length

513 mm (20.19 inches)

Width

224 mm (8.81 inches)

Container Height

195 mm (7.67 inches)

Total Height (with Terminal)

218 mm (8.58 inches)

Approx Weight

41.00 kg (90.20 lbs)

Terminal / Layout

(+-)

Container Material

Polypropylene

Lid Design

Labrynth Lid

Base Hold Down

B0

# Product Dimension & Design

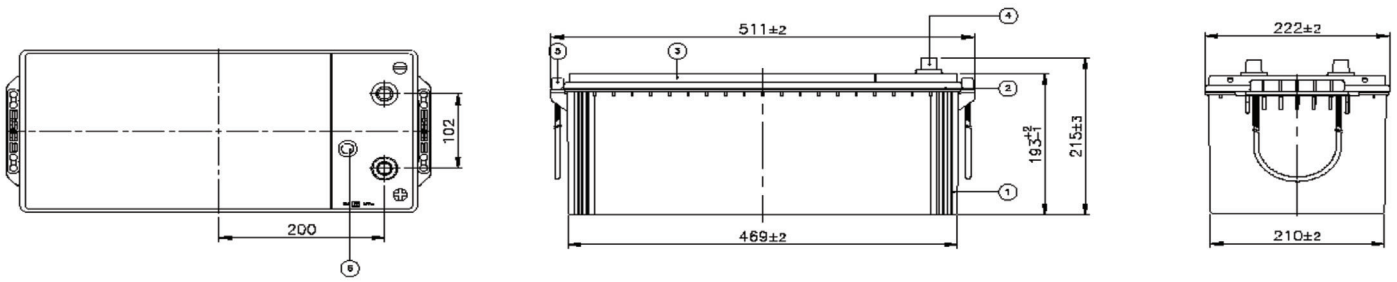

# Product Performance Overview

## Depth of Discharge Cycling Test

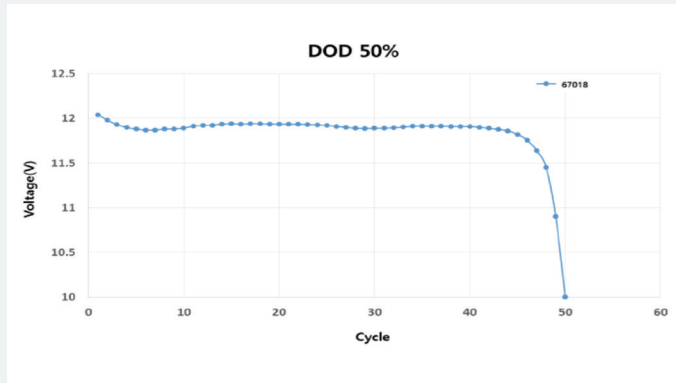

## Discharge Characteristics Test

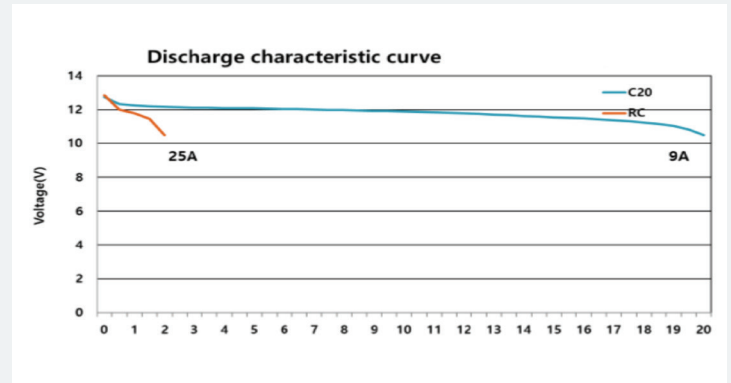

Your address for genuine Bosch quality:

**Dealer stamp here:**